

Valve sensors

**IN5225**

IND3004DBPKG/US  
Inductive sensor  
Rectangular, plastics  
Connector

Sensing range 4 mm [nf]  
non-flush mountable

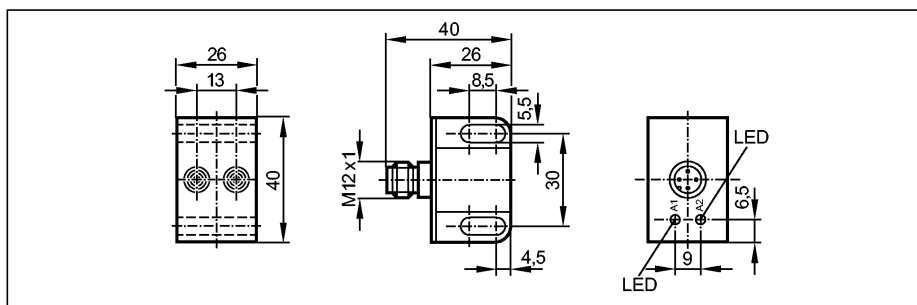

Made in Germany

**Electrical design**

**Output**

Operating voltage	[V]
Current rating	[mA]
Short-circuit protection	
Reverse polarity protection	
Overload protection	
Voltage drop	[V]
Current consumption	[mA]
Real sensing range (Sr)	[mm]
Operating distance	[mm]
Switch-point drift	[% of Sr]
Hysteresis	[% of Sr]
Switching frequency	[Hz]
Correction factors	
Ambient temperature	[°C]
Protection	
EMC	
MTTF	[Years]
Housing materials	
Function display	
Switching status	LED
Connection	
Weight	[kg]

**DC PNP**  
**2 x normally open**

10...36 DC
250
pulsed
yes
yes
< 2.5
< 15 (24 V)
4 ± 10 %
0...3.25
-10...10
1...15
1300
mild steel = 1 / stainless steel approx. 0.7 / brass approx. 0.4 / Al approx. 0.3 / Cu approx. 0.2
-25...80
IP 67, II
EN 60947-5-2
EN 55011: class B
1089
PBT
2 x yellow
M12 connector
0.04

**Wiring**

